



# **Resilient Seated Ductile Iron Gate Valve**

# Resilient Seated Ductile Iron Gate Valve

## Design

The Waterworks Resilient Seated Ductile Iron Gate Valves are suited to applications in the wastewater and water treatment industries. Key features include an oversized shaft, double shaft seals and twin lip seals that effectively safeguard against the infiltration of foreign substances. These valves are manually operated via a non-rising stem handwheel, and all bolt holes are filled with silicone to prevent water accumulating and causing corrosion.

## Sizes

50mm – 200mm.

## Temperature Range

0°C to 80°C.

## Pressure Rating

0 - 16Bar.

## Approvals & Certifications

Handwheel – AS2638.2 & AS4087 PN16 Flanged (Table D)



Model	DN (mm)	Turns For Full Cycle	Pressure Range	Media Temperature	Weight (kg)
GVC-050	50	12	0-16 Bar	0-80°C	9
GVC-065	65	12	0-16 Bar	0-80°C	12
GVC-080	80	19	0-16 Bar	0-80°C	14
GVC-100	100	23	0-16 Bar	0-80°C	22
GVC-150	150	32	0-16 Bar	0-80°C	33
GVC-200	200	35	0-16 Bar	0-80°C	51

# Technical Information

## Dimensions:

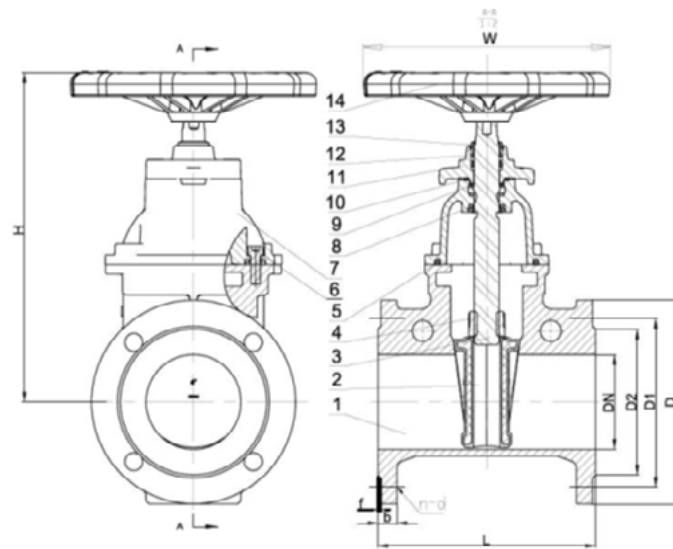

DN	L	D	D1	D2	b	f	n-d	H	W
50	178	150	114	90	18	3	4-18	270	180
65	190	165	127	103	18	3	4-18	280	180
80	203	185	146	122	18	3	4-18	290	200
100	229	215	178	154	20	3	4-18	315	200
150	267	280	235	211	23	3	8-18	410	280
200	292	335	292	268	23	3	8-18	515	320

All dimensions in mm unless shown otherwise.

## Materials:

Number	Part	Material
1	Body	Ductile Iron
2	Wedge	Ductile Iron & EPDM
3	Stem	431 Stainless Steel
4	Stem Nut	Bronze C83600
5	Bonnet Gasket	EPDM
6	Bolt	316 Stainless Steel
7	Bonnet Gasket	Ductile Iron
8	Up Sealing	NBR
9	Washer	Nylon
10	Bushing Nut	Bronze C83600
11	O-Ring	NBR
12	O-Ring	NBR
13	Dust Guard	NBR
14	Handwheel	Ductile Iron



SCAN ME

Scan the QR code to view our Resilient Seated Ductile iron Gate Valve online.



Contact us to discuss your pipeline project 0800 387 677



Auckland | New Plymouth | Wellington

Head Office: 90 Hurlstone Drive, New Plymouth

e: support@waterworks.nz

[www.waterworks.nz](http://www.waterworks.nz)